

**Operator for swing gates up to 1,000 lbs weight and 20 ft length each.** Post mounted, with articulating arm, perfect for **heavy duty commercial and residential continuous operation**, as well as farms and ranches. Great innovative functions with the new 1050 circuit board.

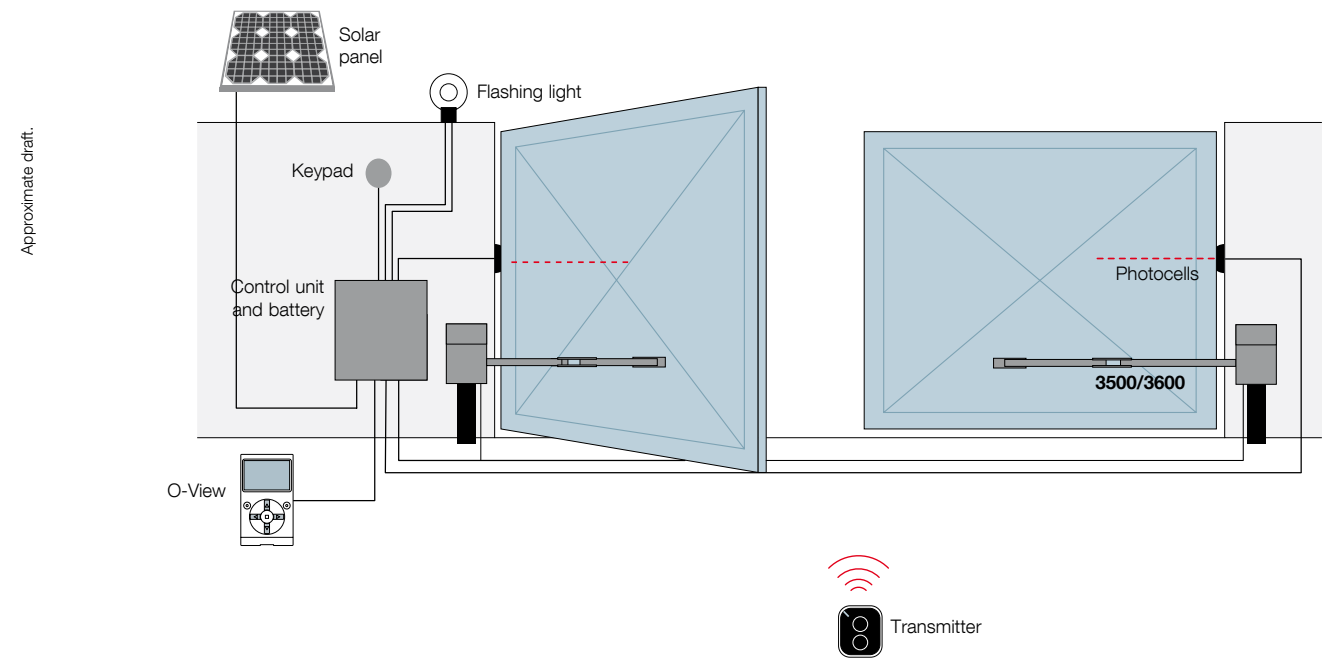

### Gate setup



**Versatile:** available in 3500ETL-1K single version and 3600ETL-1K dual gate version, containing an additional chassis, arm kit and 42 ft. of cable.

**Solar compatible:** optional 12 V battery (required) can be charged by either solar or AC power. The choice is yours!

**Easily installed** on most existing or new gates, with practical adjustment of the extension arm and limit switches. The motor's low profile design allows for compact installation. A 4x4 post with heavy wall tubing is recommended.

Both models use the single/dual advanced **1050 circuit board** offering:

- LCD display for easy programming, diagnosing and troubleshooting;
- Innovative obstacle detection system;
- Plug-in receiver: up to 1,000 rolling-code transmitters;
- Smart management of the battery charging;
- Integrated 7 day timer;
- Master/slave management for two motors working together;
- Protection against electrical surges;
- Programmable inputs for external accessories.

**Quality and durability** with the corrosion resistant housing.

**Safe**, the arm design eliminates major pinch points.

### Nice transmitters and accessories to control and make safer your automation system:



**INTI**  
2-channel transmitters 433.92 MHz, rolling code system with self-learning function. Available in 6 different colors.



**ERA ONE**  
2, 4-channel 433.92 MHz transmitters with management of Identity Codes and Certificates.



**MOTB**  
12-key digital selector.



**MOFB**  
One couple of photocells.



**ML24T**  
Flashing light with integrated aerial.



**LP1 - LP2**  
Loop detectors.

Code	Description	Approvals
3500ETL-1K	Operator 12 Vdc for swing gates up to 16 ft. and 600 lbs. each, single gate version. 1050 circuit board.	ETL
3600ETL-1K	Operator 12 Vdc for swing gates up to 16 ft. and 600 lbs. each, dual gate version. 1050 circuit board.	ETL

### Technical specifications

Code	3500ETL-1K	3600ETL-1K
<b>Electrical data</b>		
Power Supply (Vdc)	12-30	
Operation (Vdc)	12	
Absorption - standby (mA)	10	
<b>Performance data</b>		
Speed open 90° (s)	12-20	
Duty Cycle (cycles/hour)	Varies based on charging capacity	
<b>Dimensional and general data</b>		
Working Temp (°F Min/Max)	-40 ÷ +150	
Dimensions - Control Box (inches)	18x18x8	
Dimensions - Actuator (inches)	17.8x12x8.3	

### Dimensions

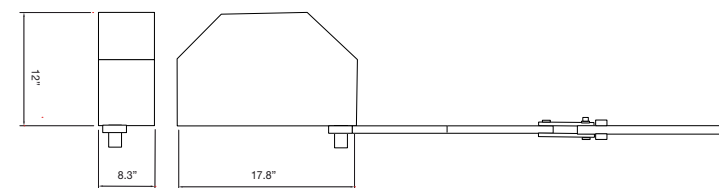

### Application



Versatile post mounted operator with articulating arm, for swing gates up to 1,000 lbs and 20 ft. Perfect for heavy duty commercial and residential continuous operation.